

Disney's Wilderness Lodge & Villas

This Disney Deluxe Resort and Disney Deluxe Villa Resort celebrates the grandeur of the glorious national parks of America's great Northwest. Your clients will bask in the harmony of natural elements while they sample the beauty and majesty of the great outdoors.



Room Accommodations

- 698 rooms, 27 suites, 181 villas
- Standard rooms accommodate up to four Guests, plus one child under age 3 in a crib.
- All rooms have two queen-size beds, or one queen-size bed and bunk beds, or one king-size bed and private balcony or patio.
- Guests choosing **Club Level** accommodations at the *Old Faithful Club* receive personalized concierge service and lounge with continental breakfast, midday snacks and evening wine, hors d'oeuvres, cordials and desserts.



- | | |
|--------------------------------|--------------------------------|
| 1 Registration/Lobby/Concierge | 13 Silver Creek Spas |
| 2 Whispering Canyon Cafe | 14 Water Launch Service |
| 3 Wilderness Lodge Mercantile | 15 Fire Rock Geyser |
| 4 Buttons & Bells Arcade | 16 Trout Pass Pool Bar |
| 5 Territory Lounge | 17 Teton Boat & Bike Rental |
| 6 Artist Point | 18 Nature Trail |
| 7 Roaring Fork | 19 Hidden Springs Spa |
| 8 Guest Laundry Facility | 20 Hidden Springs Pool |
| 9 Silver Creek Falls | 21 Bike & Jogging Path |
| 10 Silver Creek | 22 Sturdy Branches Health Club |
| 11 Silver Creek Springs (pool) | Bus Transportation |
| 12 Wading Pool | |

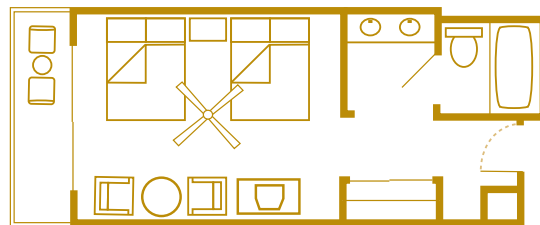

Typical Standard Room, Woods & Courtyard View, with 2 queen-size beds, 340 sq. ft. Accommodates up to four Guests plus one child under age 3 in a crib.

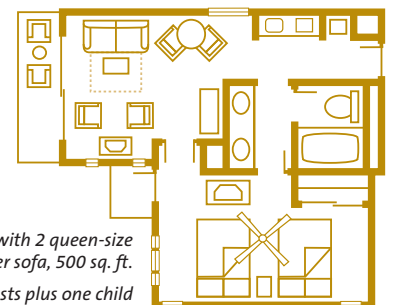

Typical 1-Bedroom Deluxe Room with 2 queen-size beds and 1 queen sleeper sofa, 500 sq. ft. Accommodates up to six Guests plus one child under age 3 in a crib.

DISNEY'S WILDERNESS LODGE & VILLAS



1-Bedroom Deluxe Room



Presidential Suite



Standard Room

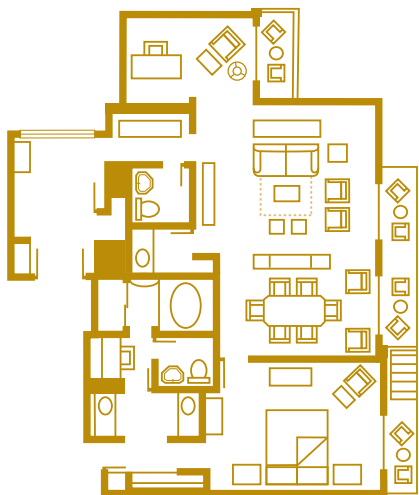

Typical Presidential Suite with 1 king-size bed and 1 queen sleeper sofa, 1,000 sq. ft. Accommodates up to four Guests plus one child under age 3 in a crib.

Dining

Signature Dining

- *Artist Point* – Serving American cuisine with Pacific Northwest flavors for dinner. The ambience is inspired by the rustic yet elegant dining rooms in cherished national park lodges.

Unique and Themed Dining

- *Whispering Canyon Cafe* – Family-style, all-you-care-to-enjoy Family Platter for breakfast and BBQ Family Platter for lunch and dinner

Quick-Service Dining

- *Roaring Fork* – Breakfast, lunch, dinner and snacks

Other Dining Options

- Lounge serving appetizers, poolside snack bar and room service



Recreation

- Two heated swimming pools, whirlpools, children's pool, themed waterslide, health club
- Health club, fishing, water play area, marina watercraft and bike rental, playground and recreation activities including Disney Movies Under the Stars and new balance® RUNNING TRAIL

Transportation

- Water launch service to Magic Kingdom® Park and select Disney Resort hotels
- Bus service to other Walt Disney World® Resort locations

Boulder Ridge Villas at Disney's Wilderness Lodge

Villa Accommodations

Two-Bedroom Villas accommodate up to eight Guests, plus one child under age 3 in a crib, and offer a fully equipped kitchen, master bedroom, second bedroom, two full bathrooms, washer and dryer, DVD player and private porch or balcony.

One-Bedroom Villas accommodate up to four Guests, plus one child under age 3 in a crib, and offer a fully equipped kitchen, king-size bed in master bedroom and queen-size sleeper sofa in living room, washer and dryer and private porch or balcony.

Deluxe Studios accommodate up to five Guests, plus one child under age 3 in a crib, and have a kitchenette, one queen-size bed, double-size sleeper sofa and private porch or balcony.

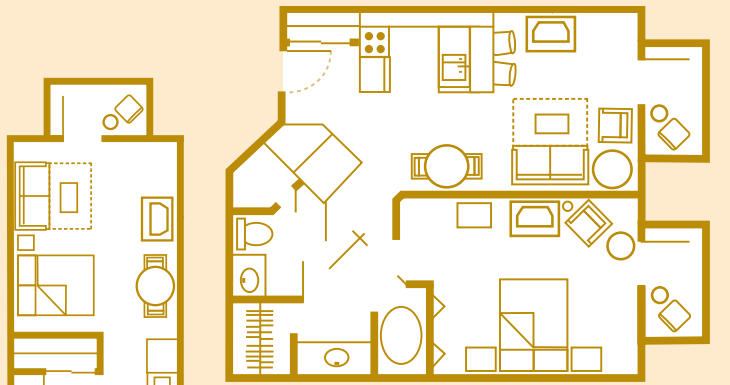

Typical 1-Bedroom Villa, 727 sq. ft. Accommodates up to four Guests plus one child under age 3 in a crib.

Typical Deluxe Studio, 356 sq. ft. Accommodates up to five Guests plus one child under age 3 in a crib.

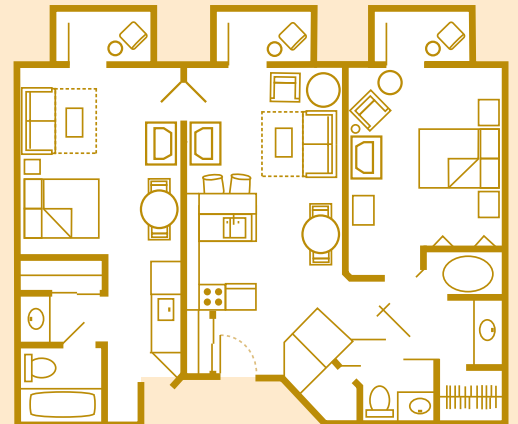

Typical 2-Bedroom Villa, 1,080 sq. ft. Accommodates up to eight Guests plus one child under age 3 in a crib.